

Austin Squares

Republic Square



Source: Foxtrot



Source: Austinway.com

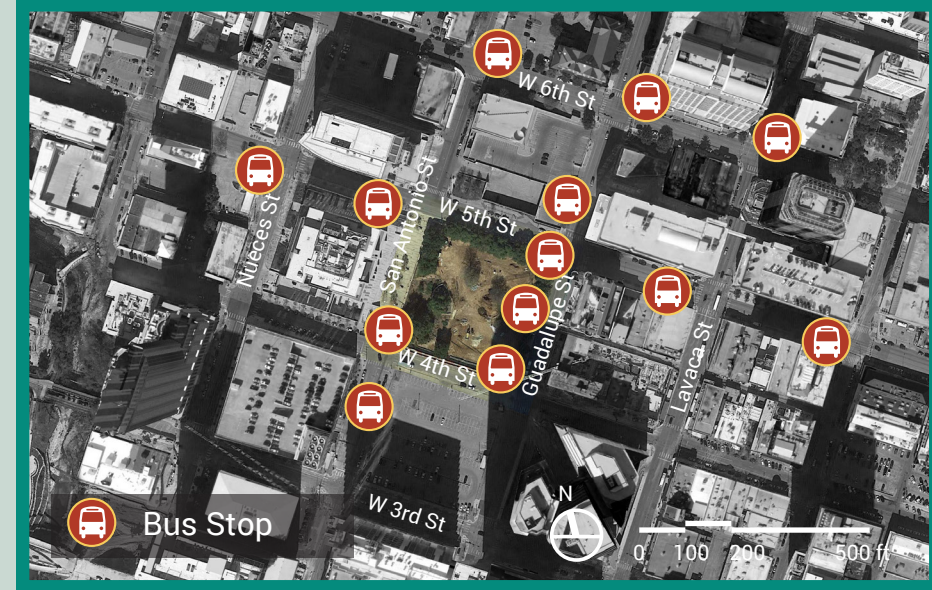

Source: Google Earth

Size

2 acres

History

Built: 1839 (platted as "Public Square"), 1888 (named)

Renovated: 1976, 2017

Wooldridge Square



Source: Wikipedia



Source: The Austin Chronicle

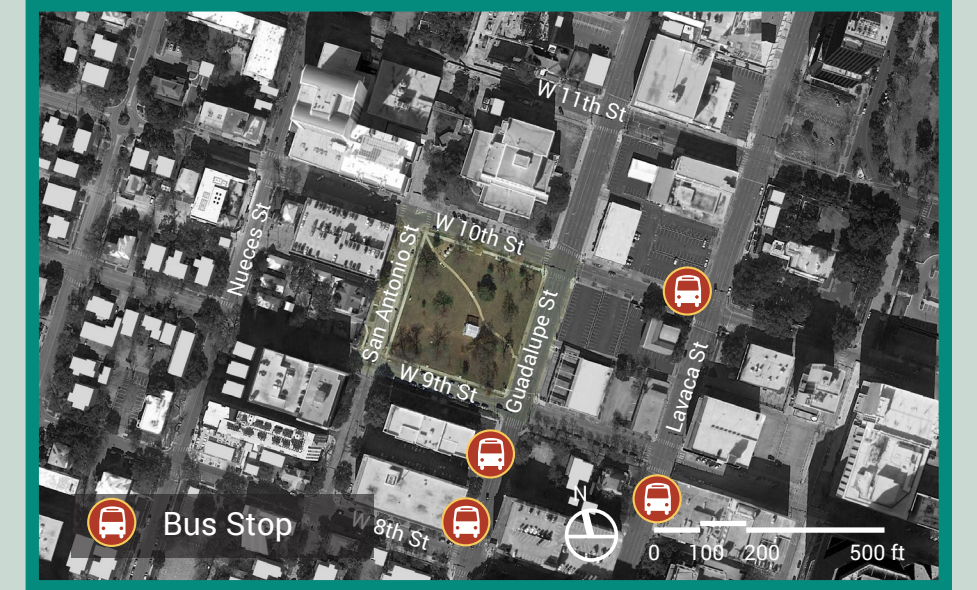

Source: Google Earth

Size

2 acres

History

Built: 1839 (platted as "Public Square"), 1888 (named)

Renovated: 1909

Downtown Austin Plan

Short Range

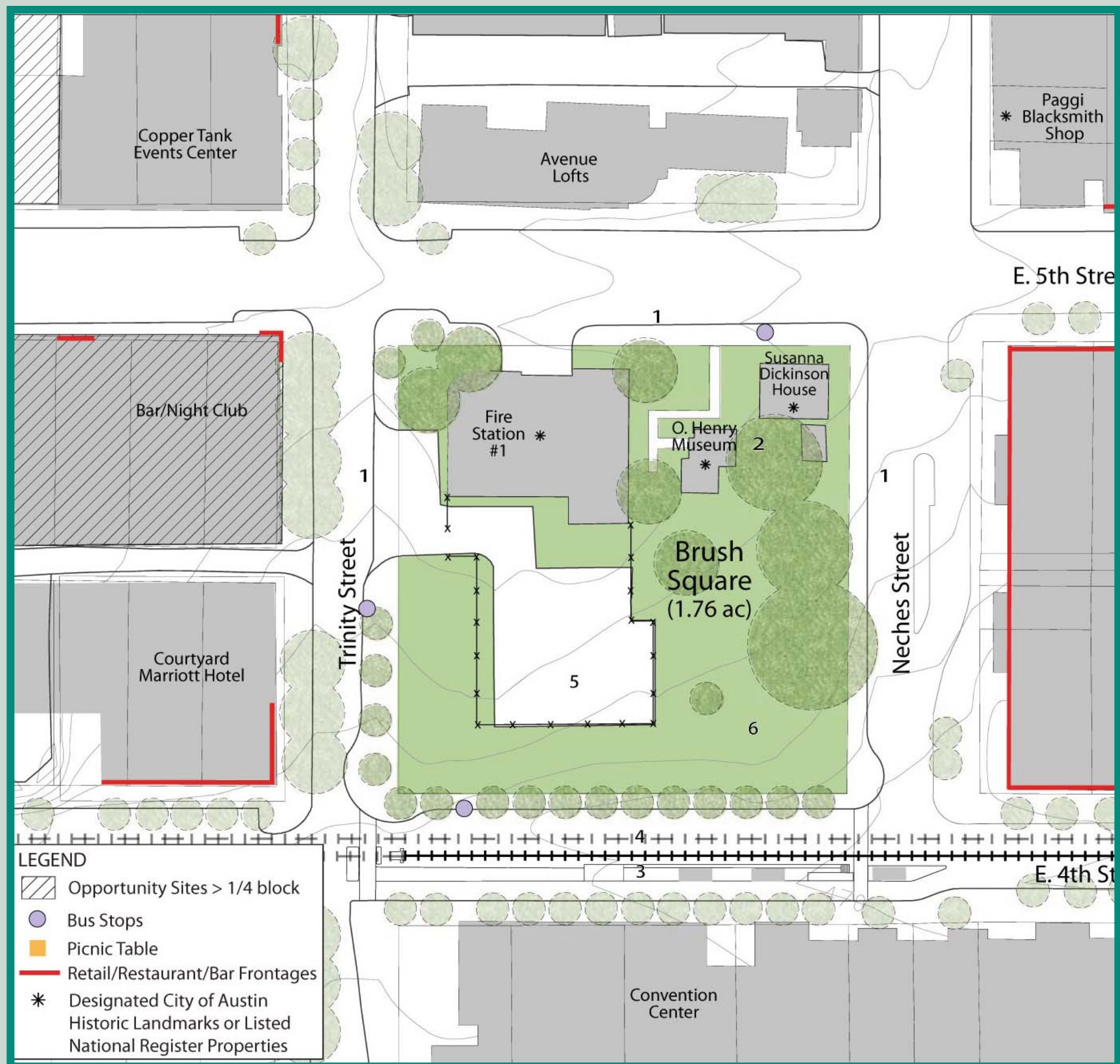

Source: <http://www.austintexas.gov>

- Reduce the impact of the Austin Fire Department parking lot, both visually and spatially.
- Accommodate better day-to-day, informal use of the square.

Long Range



Source: <http://www.austintexas.gov>

- Create visitor-oriented park with a cultural emphasis that also supports daily use by nearby residents and employees.
- Maintain and enhance as a landscape refuge.
- Ensure the park can support a variety of types and sizes of events and gatherings.