



# Austin Strategic Mobility Plan



MCAC February 12, 2018

Austin Transportation Department



# Agenda

Schedule Update  
Phase II Public Engagement Activities  
Scenario Planning Update  
Group Discussion and Report Out

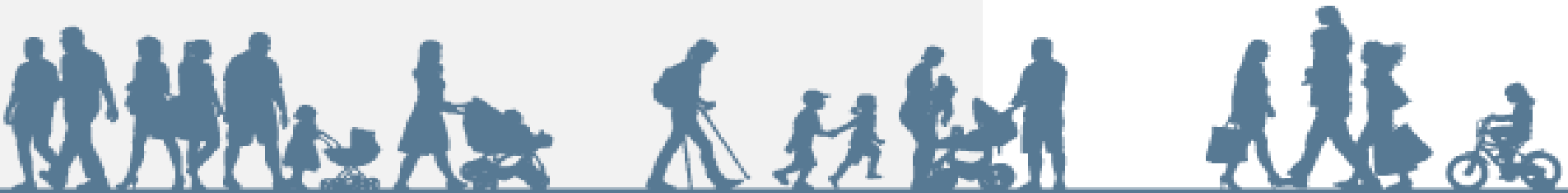

# Schedule Update



# Where are we now

2016

2017

2018

Oct Nov Dec | Jan Feb Mar Apr May Jun Jul Aug Sep Oct Nov Dec | Jan Feb Mar Apr May Jun Jul Aug Sep Oct Nov Dec

Establish  
Advisory  
Committee &  
Public  
Engagement  
Plan

Phase 1  
Outreach  
begins

Phase 1  
Outreach  
closes

Phase 2  
Outreach  
begins

Mobility  
Strategy  
review

Approval  
Process  
starts

**Project Initiation &  
Phase 1 Public Outreach**

**Scenario  
Planning/Analysis &  
Phase 2 Public  
Outreach**

**Preferred  
Strategy**

**Plan  
Review  
&  
Adoption**



# Public Engagement



# Phase II Public Engagement

- Traffic Jam – Feb. 24
- MetroQuest
- Historically marginalized communities focus
  - Focus groups
  - Employer-based engagement
  - Coordination w/ Project Connect mobile engagement

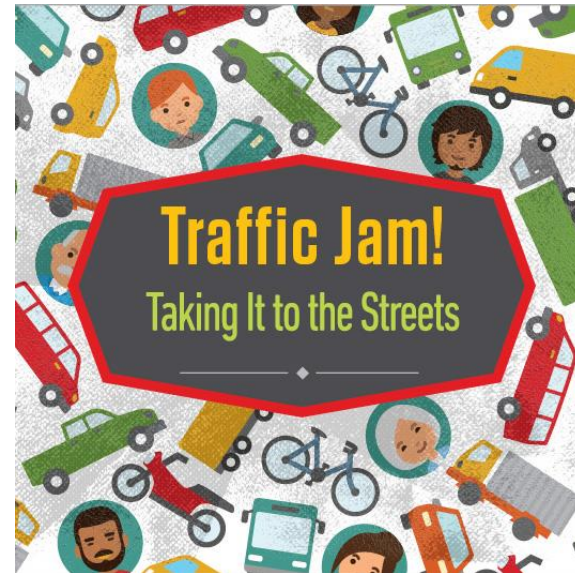

# Traffic Jam

- Saturday, Feb. 24
- 9am-1pm
- Central Library
- Open house style
- Speakers at 10
- Coffee, snacks

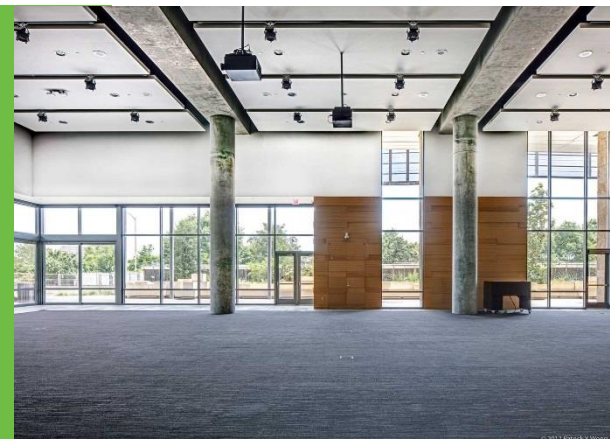
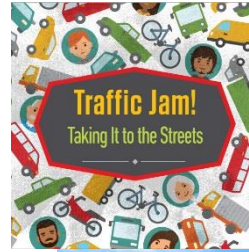

# Traffic Jam – ASMP Stations

## Explore the Scenarios

### Ingredients of the Plan

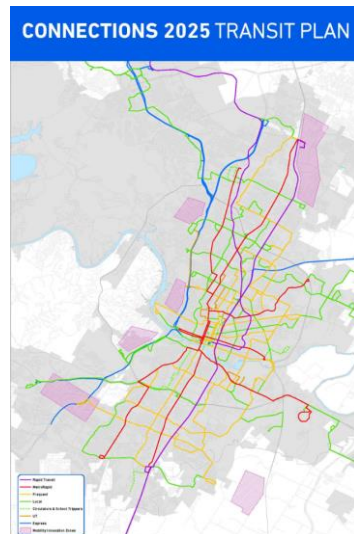
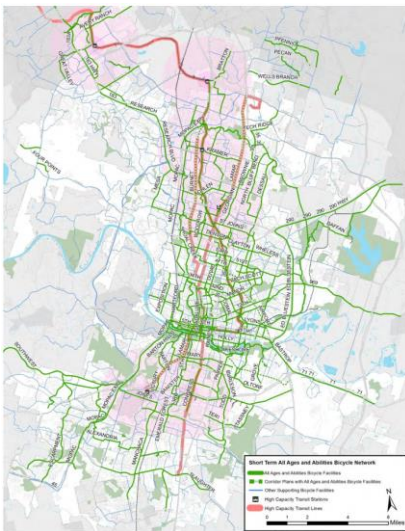

### Scenario A

Description Ingredients Likes Dislikes "How would you rate this scenario?"

### Scenario B

Description Ingredients Likes Dislikes "How would you rate this scenario?"

### Scenario C

Description Ingredients Likes Dislikes "How would you rate this scenario?"

### How Do They Perform?

Goal	A	B	C
<b>Efficiency</b> Reduce the amount of time drivers spend waiting between lanes and work.	Good	Better	Best
<b>Accessibility</b> Improve pedestrian and wheelchair accessibility and the ability to make transfers between modes at transit stations.	Good	Best	Best
<b>Equity</b> Lower the cost of traveling to transit by providing affordable fare options.	Good	Best	Best
<b>Transit</b> Provide economic growth for transit and the city through transit-oriented development and transit-oriented development that meet the needs of the community.	Good	Best	Best
<b>Accessibility</b> Add a transportation network that encourages active mobility through multi-modal transit and transit-oriented development that meet the needs of the community.	Best	Good	Best
<b>Equity</b> Reduce the cost of traveling to transit by providing affordable fare options.	Best	Good	Best
<b>Equity</b> Provide economic growth for transit and the city through transit-oriented development and transit-oriented development that meet the needs of the community.	Best	Best	Good

Share Your Thoughts!
A
B
C



# MetroQuest

- Screen 1: Introduction to the ASMP
- Screen 2: Priority Ranking (*results of Phase I*)
- Screen 3: Scenario Rating
- Screen 4: Survey Questions
- Screen 5: Wrap-up, demographic questions

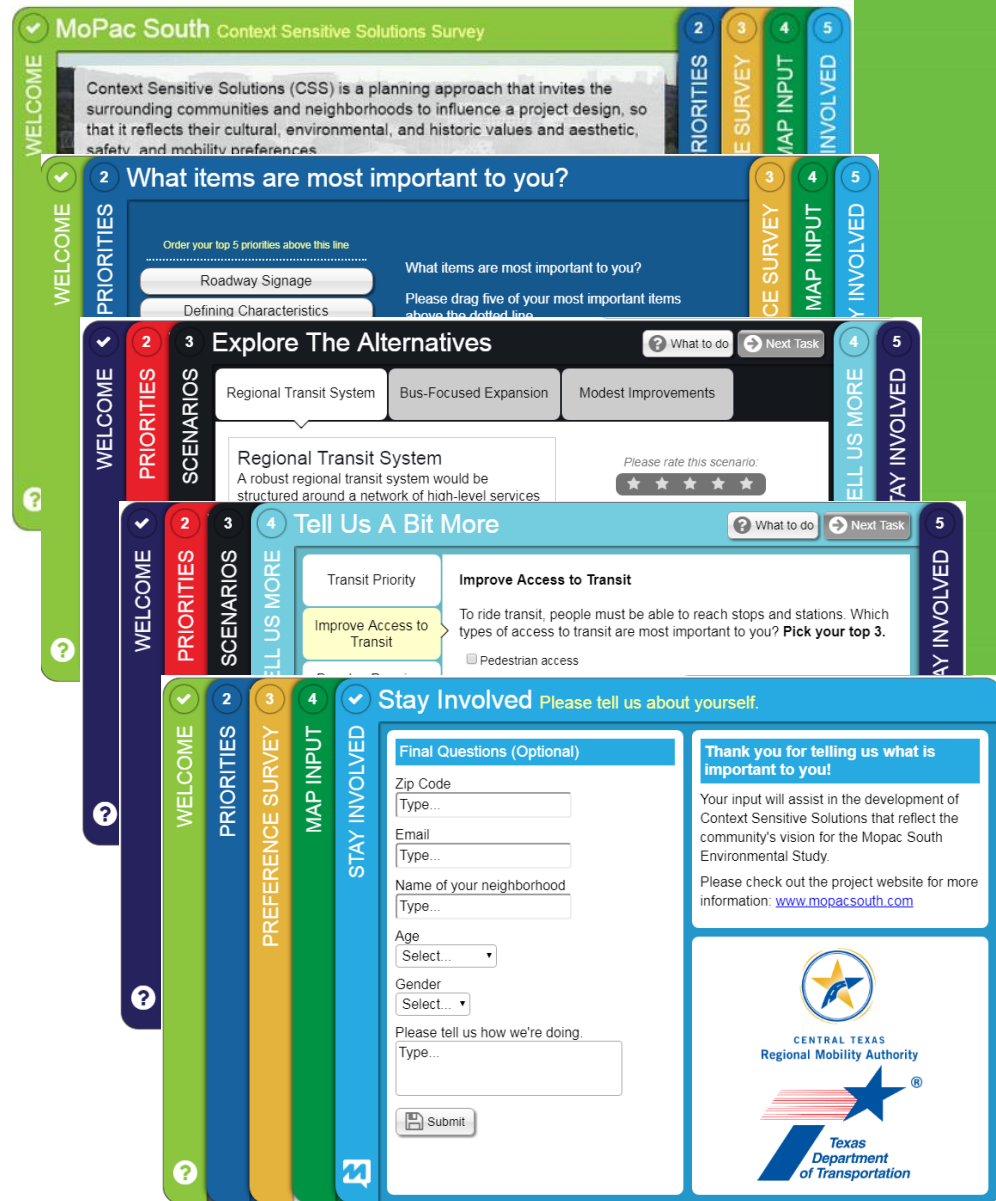

# Scenario Planning Update



# What is Scenario Planning?



Scenario Planning | *noun*

*Def:* A method to explore how well different **mobility strategies** make progress towards achievement of **goals and objectives**.

**Projects + Programs + Policies**



# Building our Scenarios

Learn from  
Imagine Austin  
Scenarios,  
developing the  
Mobility Vision

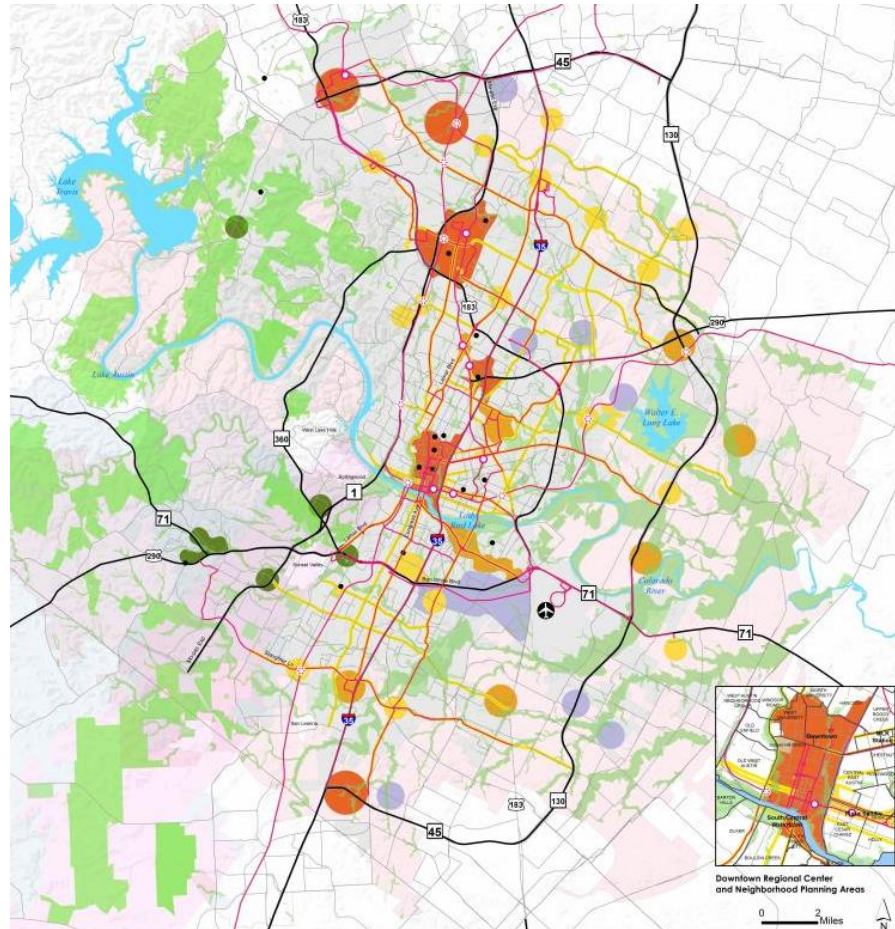

# Scenarios



## Scenario A

Assumptions: Scenario A continues the current trend of transportation programming, investments and policy in Austin. This scenario assumes implementation of projects for roadways, public transit, bicycle, and pedestrian systems throughout the city. The scenario maintains the current trend of investments for all modes, existing levels of transportation demand management programming, and anticipates a small impact from automated and connected vehicles.

# Scenarios



## Scenario B

Assumptions: Scenario B modifies transportation programming, investment, and policy in Austin. This scenario increases the distribution of support for roadway, public transit, bicycle, and pedestrians along Imagine Austin Activity Corridors and within Activity Centers. The scenario assumes higher levels of transportation demand management programming and a modest impact from automated and connected vehicles.

# Scenarios



## Scenario C

Assumptions: Scenario C significantly modifies transportation programming, investment, and policy in Austin. This scenario includes the highest degree of distribution amongst roadway, public transit, bicycle, and pedestrians along Imagine Austin Activity Corridors and within Activity Centers. The scenario assumes the highest level of transportation demand management programming and the highest impact of automated and connected vehicles on public transit, ridesharing and freight.

# Motivation behind the Scenarios

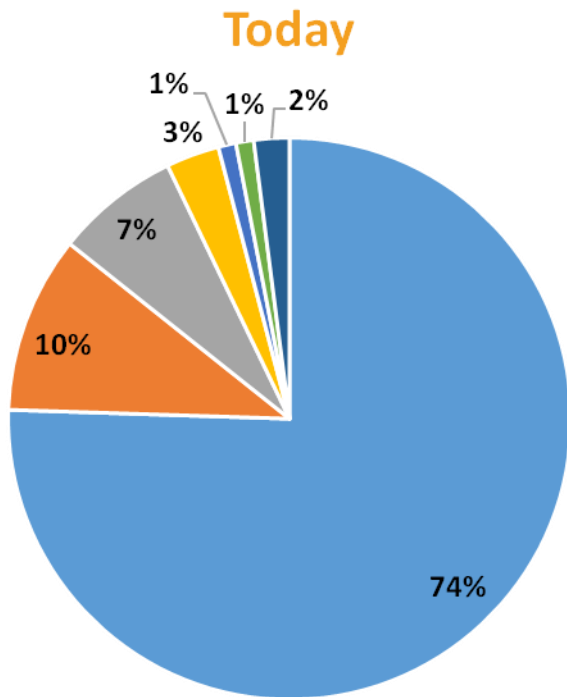

- Drive Alone
- Carpool
- Work at Home
- Transit
- Taxicab, motorcycle or other means
- Bike
- Walk

**FUTURE**

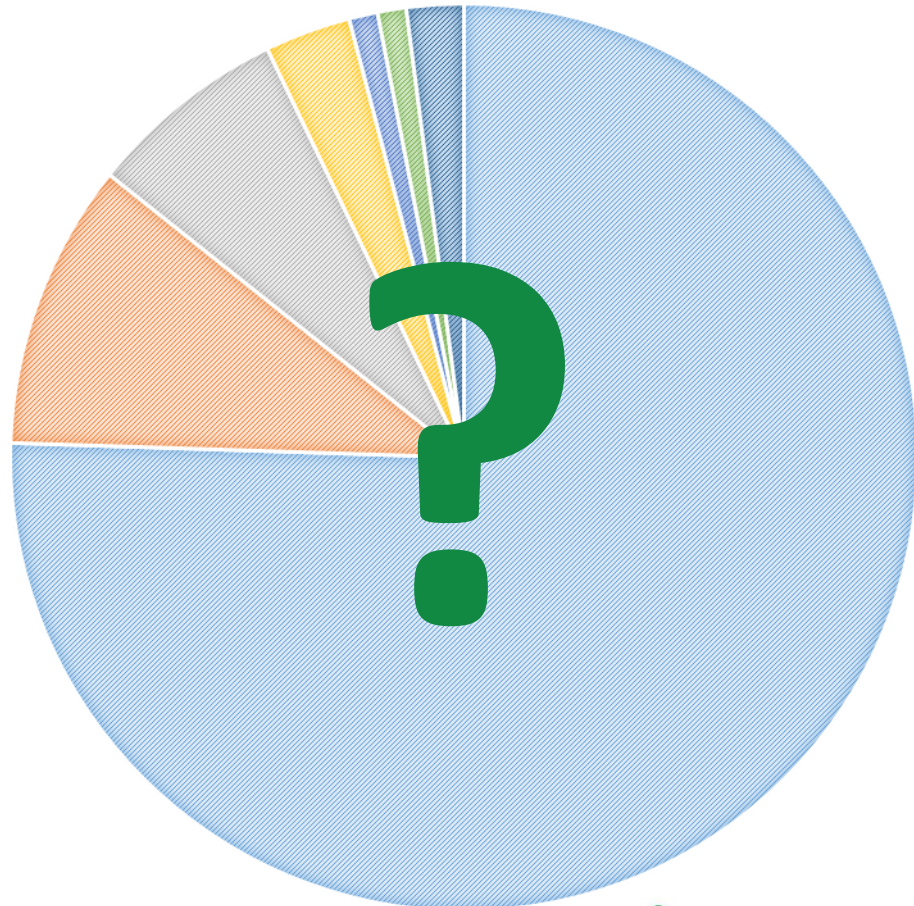



# Scenario Ingredients

- Travel Demand Model + Spatial Analysis
- Inclusion of Connections 2025
- Varying levels of investments, geographies
  - Project Connect
  - Bicycle Master Plan
  - Urban Trails Master Plan
  - Sidewalk Master Plan/ADA Transition Plan
  - Roadway capacity
  - Corridor Plans/Reports
- Other assumptions
  - Transportation Demand Management (TDM) programs, policies
  - Intelligent Transportation System (ITS)
  - Other innovative mobility strategies

# Table Discussion



# At your table, 2 rounds:

1. What do you like or not like about the Scenario Ingredients? Rate the Scenarios: 1 to 5 ★
  - Quiet time (3-4 min)
  - Group Discussion (15 min)
2. Which transportation strategies do you believe would best address \_\_\_\_\_?
  - Quiet time (3-4 min)
  - Group Discussion (15 min)

Report Out – time permitting

# Scenario Results

Placeholder: will be based on report card handout K-H is producing. Will update on 2/12.

Summary of:

- Scenario Inputs
- Scenario Outputs
- Spatial Analysis





Which transportation strategies do you believe would best address commuter delay?

- Offer more choices in how we can travel such as bicycling, walking and transit
- Improve signal timing and other transportation technologies
- Promote flexible work hours and teleworking through policies and programs
- Prioritize transportation projects and policies that support opportunities to live, work and play in close proximity
- Provide new roadway connections and additional capacity for vehicles



Which of the following strategies do you feel would best promote health and safety?

- Prioritize projects across the city that promote walking and biking as a mode of transportation for short trips
- Increase education and enforcement of traffic laws
- Provide more options for travel to healthcare facilities, healthy food providers and activity centers such as parks
- Plan for and use autonomous and/or connected vehicle technology to reduce human error

Affordability



Which of the following strategies do you feel would best promote transportation **affordability**?

- Invest more transportation infrastructure and programming resources in historically marginalized communities
- Offer more choices in how we travel to reduce personal costs associated with car ownership
- Prioritize transportation projects and policies that support opportunities to live, work and play in close proximity

Travel Choice



## Which of the following strategies do you would best promote more travel choices?

- Provide new and safer sidewalks and bikeways
- Provide new roadway connections and additional capacity for vehicles
- Provide more transit service, promote transit-supportive land uses and enhance connections to/from transit
- Provide more options by harnessing technology advances such as transportation network companies (e.g. Uber, Lyft, RideAustin), autonomous vehicles, teleworking and remote-working programs, etc.





## Which of the following strategies do you feel would best promote transportation **innovation**?

- Provide more transportation options by harnessing technological advances such as transit network companies (e.g. Uber, Lyft, RideAustin), autonomous vehicles, teleworking and remote-working programs, etc.
- Pilot programs and develop policies that further advance emerging electric, connected and autonomous vehicle (E-CAV) technologies
- Promote community dialogue, public engagement and education on data and mobility innovations



## Which of the following strategies do you feel would best promote economic and environmental sustainability?

- Promote transportation modes that reduce reliance on fossil fuels (such as biking, walking, transit and electric vehicles)
- Use environment-friendly materials and methods in the design and construction of transportation projects
- Ensure the transportation network is resilient and adaptable to future changes
- Prioritize transportation projects and policies that support opportunities to live, work and play in close proximity



Which of the following strategies do you feel would best support the economic prosperity of individuals and/or the region?

- Invest more transportation infrastructure and programming resources in historically marginalized communities
- Advance transportation projects that promote access to quality jobs and job centers
- Support business growth and investment by providing transportation resources in and around activity centers
- Make it easier to move goods and services through and within Austin



## Which of the following strategies do you feel would provide the best opportunity for placemaking?

- Prioritize transportation projects and policies that support opportunities to live, work and play in close proximity
- Design streets based on surrounding land uses and urban design
- Invest more transportation infrastructure and programming resources in historically marginalized communities

# Table Discussion



# Next Steps



# Reminder...

Scenarios

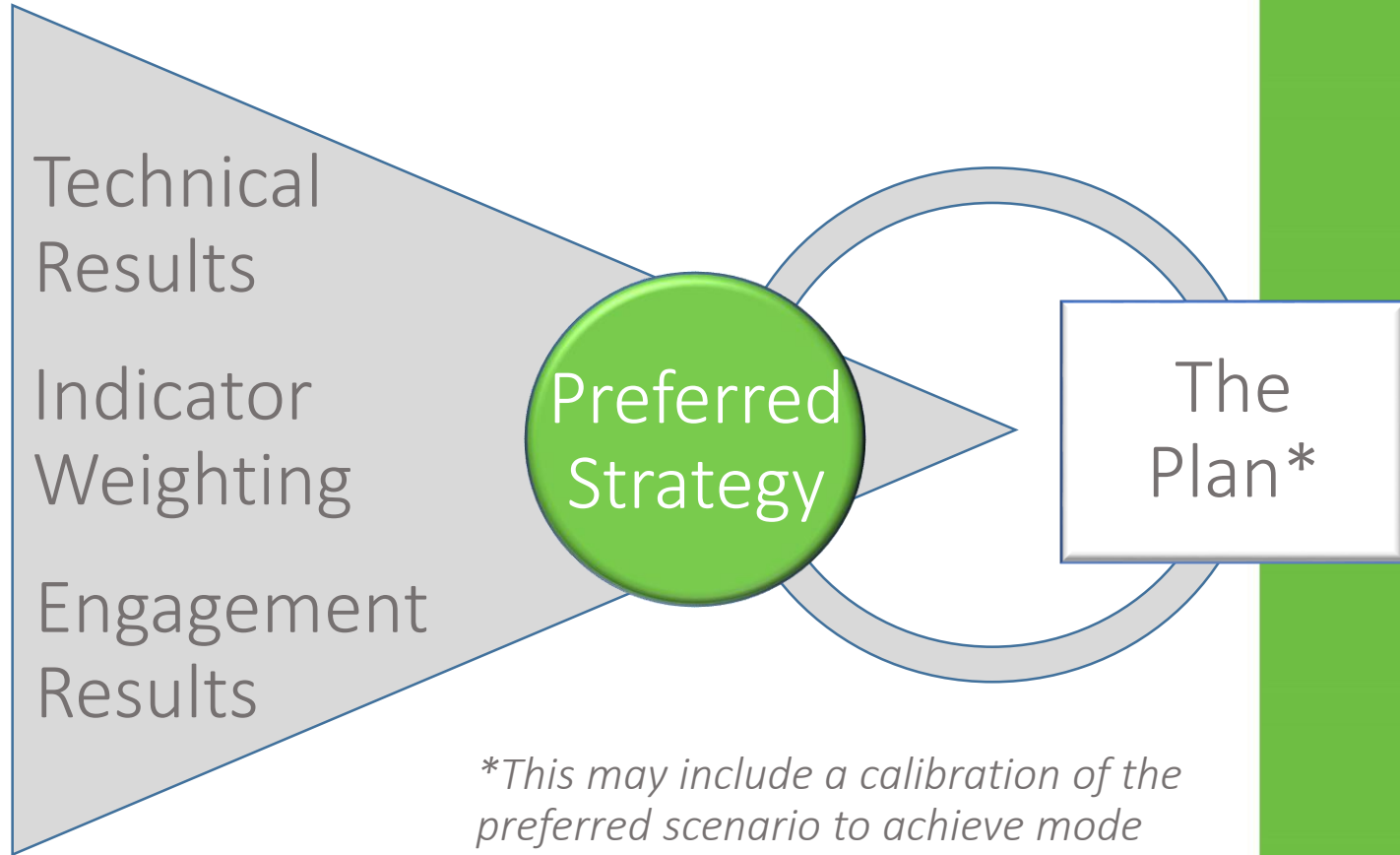

*\*This may include a calibration of the preferred scenario to achieve mode split/performance targets*

# Next Steps

- Produce Scenario Report Card
- Phase II Engagement Activities
- Build preferred strategy and write policy document
- Updated Timeline
  - February 24 – April 30: Public review of scenarios, MetroQuest survey live
  - May – September: Develop the preferred strategy and plan with public review period(s)
  - October/November: Start Boards & Commissions
  - December/January: Begin formal adoption process (Council)



# Developing the Preferred Strategy

- Land Use (CodeNEXT)
- Transit Ridership (Project Connect)
- Bicycle Network short-trip capture methodology
- Transportation Demand Management strategies
- Innovative Mobility Strategies



# Questions?



MCAC February 12, 2018  
Austin Transportation Department

